

Convi Clamp



The Convi clamp, is made of lightweight cast alloy, can be securely mounted on any tube from 5 to 51mm and equipped with a saddle for mounting onto flat surfaces. The Elastic P.U. Pad also reduces surface damage and enhances gripping action. All mental parts are made of stainless steel for sturdier and anti-rusted features. The die -casting aluminum of locking knob provides with most rugged advantage. With built-in female socket allows the use of any attachments to hold anything from backgrounds to lighting fixtures. The spring safety locking system also offers double insurance while the screw locking action is not completely finished.

KCP-700B Convi Clamp-Black
KCP-700P Convi Clamp-Silver

 20kg
44lbs

W 0.45kg
1lbs

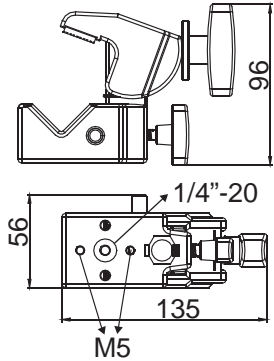

KCP-7SDL
Convi Clamp Saddle

Allow to use the clamp on most flat surfaces such as a table without tool



KCP-701P
Toothy Convi Clamp - Silver
 Designed for mounting on the trees with the teeth devices of clamp



KCP-260B
Grip Head w/Hex Stud



KCP-270B
Convi Clamp Griphead



KD-730B
Convi Clamp Double Socket-Black
KD-730P
Convi Clamp Double Socket-Silver

Offer an additional 5/8" (16mm) socket to Convi clamp



KCP-720B
Double Convi Clamp-Black
KCP-720P
Double Convi Clamp-Silver
 Assembled by two Convi Clamps provides a 90 degree angle and perfect for supporting a crossbar for background on kupoles



Application:
 KCP-270B with Grip Arm



KCP-710B Convi Clamp
 w/Adjustable Handle-Black
KCP-710P Convi Clamp
 w/Adjustable Handle-Silver



Application

