

Super Viser is built by aluminum die casting body making it sturdy and lightweight. The moveable jaws are designed for mounting on the tubes or planks upto 56 mm ( 200mm is available for longer version KCP-601). With the innovative grooved design on the threaded shaft, the both jaws can be kept on the same direction all the way. In addition to the 16mm pin terminated at the end of shaft, the unique design of 16mm socket is also built on the clamp that allows all accessories of Convi. Clamp can fit into Super viser

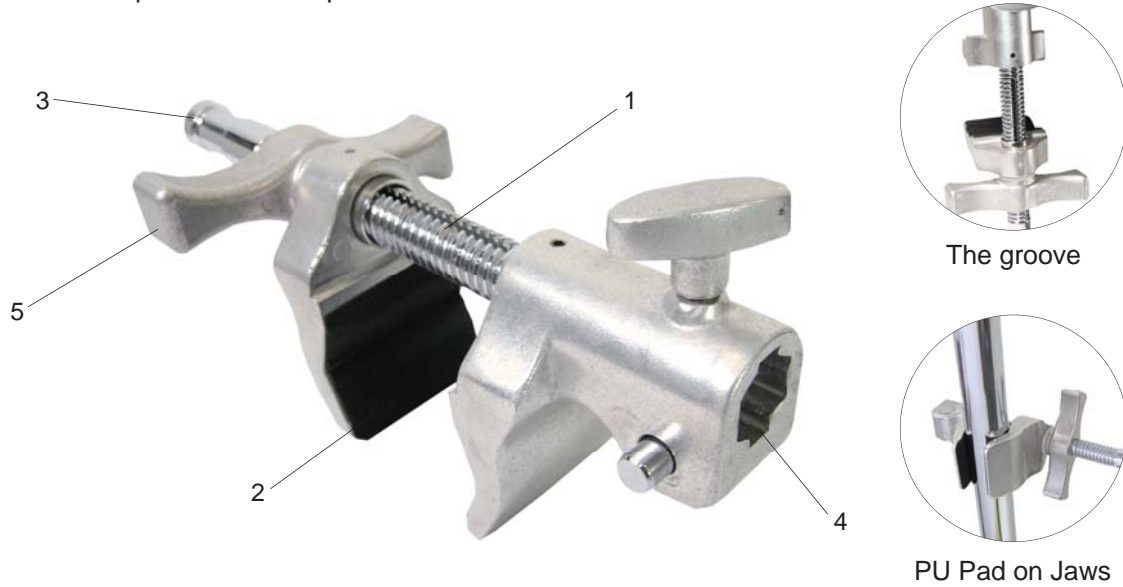

**Features:**

1. The groove on the threaded shaft keeps both jaws in the same direction all the time.
2. The P.U. pad on the jaws offer excellent grasp and protection from surface of tube s or plank.
3. The threaded shaft terminates as a 16 mm pin for mounting lighting fixtures or grip accessories.
4. The adaptor socket complements the full range of Convi clamp.
5. The ergonomically designed handle provides biggest torque.

**KCP-600 4" Super Viser**



**KCP-601 9" Super Viser**



**Application:**



KCP-605, is 11.9 inches long chain clamp with 6 inches (10 inches is also available for KCP-606) of steel chain. With the flexible chains, it can hold around any shape of wide size objects and adjust quickly by turning 5/8" baby stud in the rear of clamp. Meanwhile, the safety T-handle is also designed to eliminate any risks of unexpected looseness of the trigger.

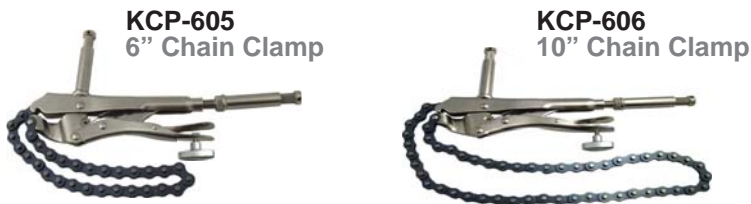

Features:

1. Ideal for holds awkwardly shaped pieces.
2. Easy to adjust pressure and fit work with turning the 5/8" baby stud in the rear of clamp.
3. The chain built by high-grade heat-treated alloy steel for maximum toughness and durability.
4. Two 5/8" baby pin provides strong support for lighting fixture with opposite directions.
5. The embossed neck of 5/8" baby studs offer the maximum friction for mounting lighting fixture.



Embossed neck offers the maximum friction



Always lock with safety T-handle for better protection.



On the tree



On the steel tube

**KCP-500 Large Gaffer Grip**

Quick release multi-purpose clamp which will grip flat surface or barrels. It comes with a tension control knob and a 5/8" socket & stud for two small fixtures or grip items. The clamp works on diameter from 1/4" to 3-1/8"

Weight: 1.25kg (2.8lbs)

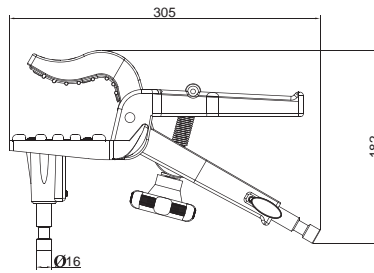

**KCP-550 Small Adjustable Gaffer Grip**

Two small fixtures or grip items can be mounted onto the 5/8" spigots including one fixed on the clamp and the other is detachable stud, which is with 3/8" and 1/4" thread, embedded in the 5/8" female receiver. Jaws is adjustable from 0.98 - 2.56" (2.5 - 6.5cm)

Weight: 0.66kg ( 1.5lbs)

